

Hydraulic valves

Restrictor valves and hose breaks valves

## Hose break valve male-female

Page: 1/1

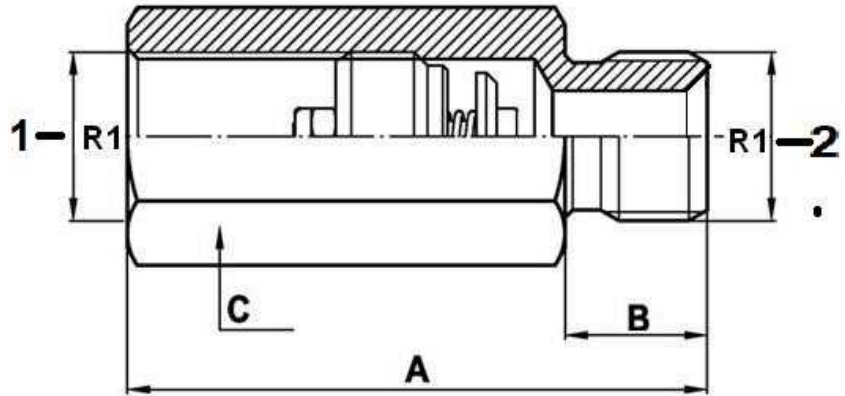
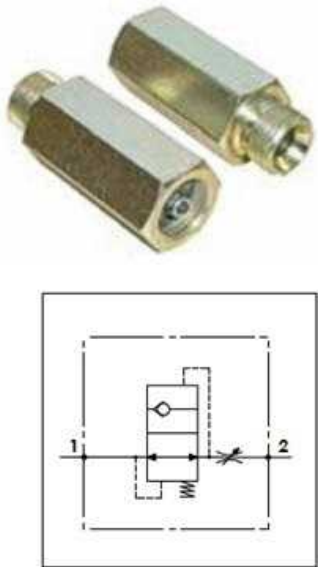

**Materials:** All components are steel made.

Part n°	R1	Max. flow (l/min)	Max. Press. (bar)	A	B	C
<b>VT007004</b>	1/4" BSP	25	350	50	12	19
<b>VT007006</b>	3/8" BSP	50	350	58	12	22
<b>VT007008</b>	1/2" BSP	80	350	70	14	27